



BOCA RATON RESORT & CLUB[®]

A WALDORF ASTORIA[®] RESORT

MEETINGS & EVENTS

CAPACITIES | DIMENSIONS

THE MIZNER CENTER

An elegant 128,000 square foot meeting venue, the Mizner Center offers 80,000 square feet of flexible function space, supported by a team of expert conference associates and the latest business technology. The Grand Lawn and Spanish Terrace augment the well-appointed rooms, offering year round use of outdoor spaces overlooking expansive lawns and gardens.

MEETING ROOM DIMENSIONS

	ROOM DIMENSIONS/ CEILING HEIGHT	SQ. FEET	SQ. METERS	MAXIMUM CAPACITY:			
				THEATER	CLASSROOM	RECEPTION	BANQUET
GRAND BALLROOM	138' x 183' x 22'9"	26,037	2,419	2,700	1,296	2,700	1,764
Salons A-D (each)	34' x 60' x 22'9"	2,158	200	234	108	230	156
Salons E-F (each)	138' x 31' x 22'9"	4,393	408	408	184	450	264
Salons G-J (each)	34' x 60' x 22'9"	2,158	200	234	108	230	156
Grand Pre-Assembly	45' x 206' x 22'	10,200	948	-	-	-	-
ROYAL PALM BALLROOM	126' x 115' x 18'	15,027	1,396	1,664	896	1,579	1,080
Salons I-IV (each)	41' x 29' x 18'	1,235	115	126	66	120	72
Salons V-VI (each)	22' x 115' x 18'	2,506	233	232	144	263	228
Salons VII-X (each)	41' x 29' x 18'	1,235	115	126	66	120	72
Royal Palm Pre-Assembly	122' x 31' x 18'	3,852	358	-	-	-	-
ADDISON BALLROOM	48' x 95' x 14'9"	4,726	439	484	240	425	336
East	48' x 48' x 14'9"	2,300	214	220	112	200	144
West	48' x 47' x 14'9"	2,550	237	220	112	200	144
Addison Pre-Assembly	45' x 30' x 14'3"	1,375	128	-	-	-	-
ESTATE BALLROOM	48' x 76' x 14'9"	3,895	362	432	228	375	288
Salon I	48' x 26' x 14'9"	1,355	126	132	63	125	96
Salon II	48' x 26' x 14'9"	1,353	126	132	63	125	96
Salon III	48' x 23' x 14'9"	1,187	110	116	56	115	96
VERANDA SALONS							
Salon I	21' x 22' x 14'9"	465	43	36	24	40	36
Salon II	19' x 25' x 14'9"	504	47	36	28	40	36
Salon III	19' x 35' x 14'9"	758	70	56	30	70	60
Salon IV	21' x 35' x 14'9"	704	65	56	30	70	60
Office I	40' x 40' x 12'	1,600	149	-	-	-	-
OUTDOOR AREAS							
Spanish Terrace	136' x 21'	3,000	279	-	-	250	156
Grand Lawn	95' x 92'	9,000	837	-	-	1,000	756

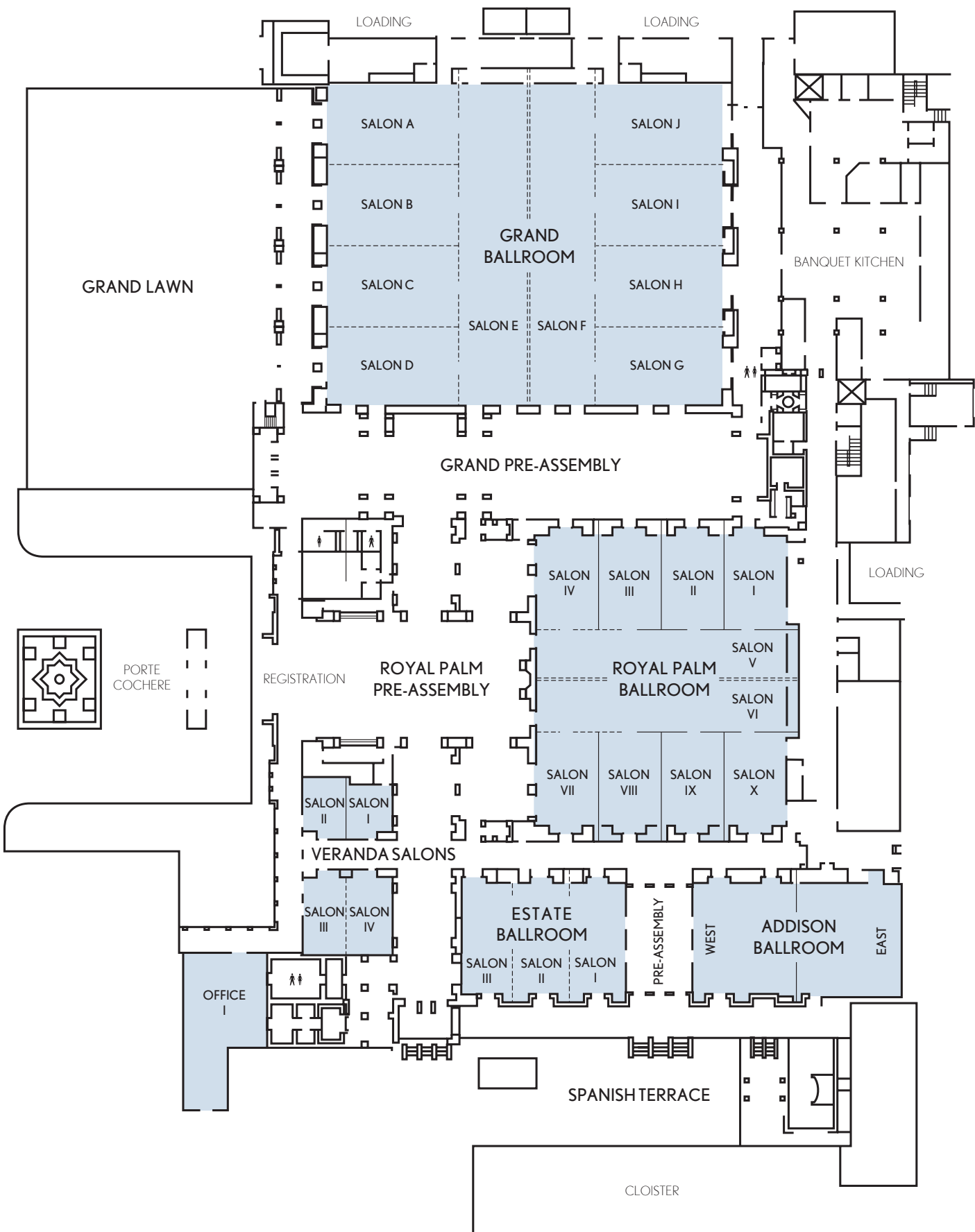

THE CLOISTER

A unique blend of vintage elegance and charm, the Resort's original signature building, The Cloister, is home to some of our most unique indoor and outdoor meeting venues, including the Cathedral dining room and Cloister Garden. While historic in nature and design, these rooms feature state-of-the-art audio/visual capabilities, a wide array of catering options and the attentive, yet unobtrusive, service for which the Resort is known.

MEETING ROOM DIMENSIONS

	ROOM DIMENSIONS/ CEILING HEIGHT	SQ. FEET	SQ. METERS	MAXIMUM CAPACITY:				
				THEATER	CLASSROOM	RECEPTION	BANQUET	CONFERENCE
Cathedral	102' × 59' × 11'	6,045	562	300	100	400	336	-
Cloister Garden	-	-	-	-	-	300	156	-
Valencia (Stage)	55' × 51' × 16'	2,805	261	288	152	300	168	46
Galeria	75' × 41' × 9'	3,075	286	259	100	250	168	64
Galeria North	41' × 36' × 9'	1,476	137	112	48	100	72	24
Galeria South	41' × 36' × 9'	1,599	149	112	48	100	84	24
Mizner Room	54' × 37' × 10'	1,944	181	234	96	200	144	46

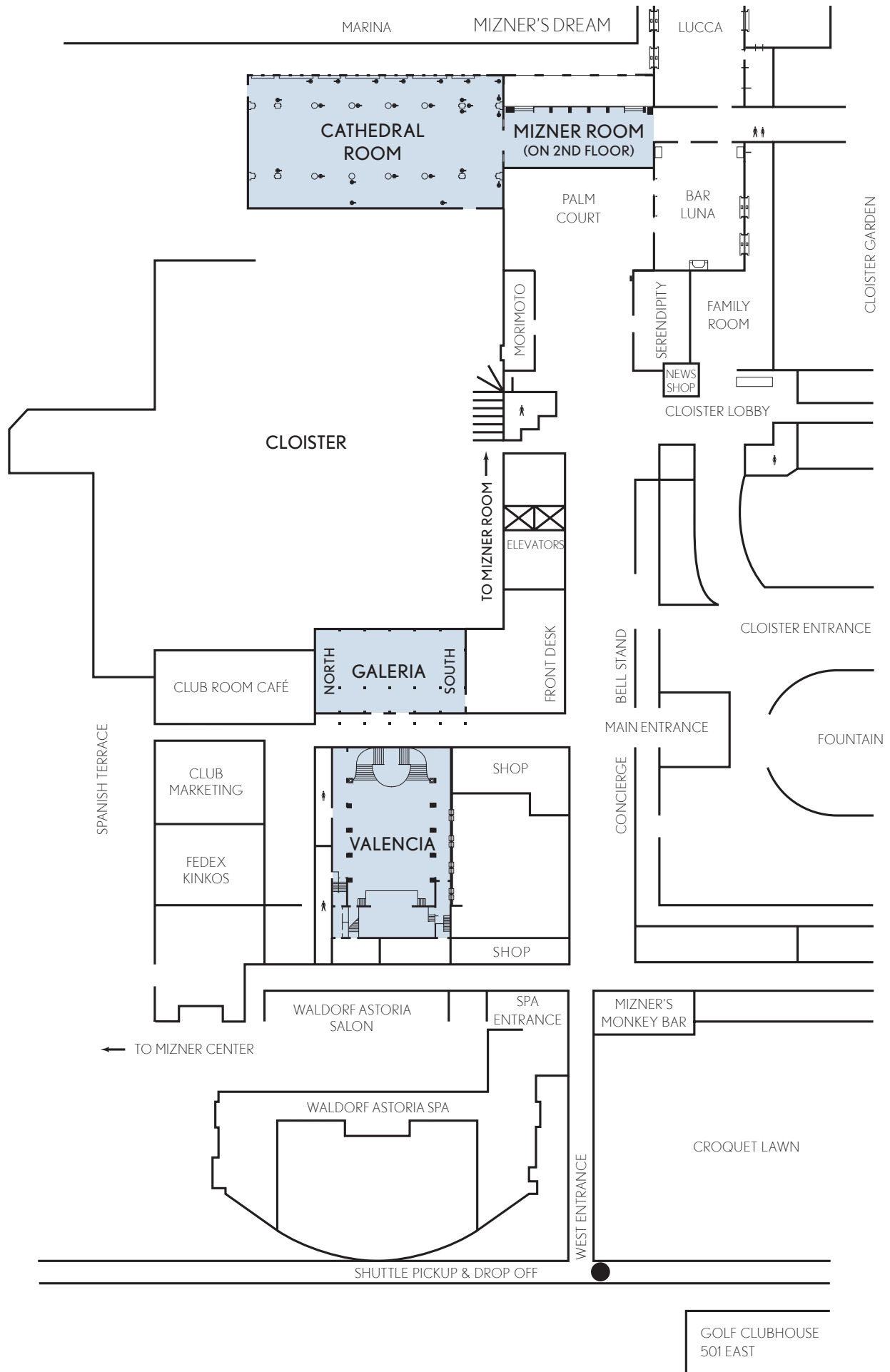

THE GREAT HALL CENTER

The Great Hall Center offers 12 versatile function rooms, all proportioned to allow flexibility in scale, seating and configuration – a dinner for 25 or a creative presentation for 1,200. Great Hall features a dramatic floor-to-ceiling glass wall with stunning views of the Intracoastal Waterway. Centrally located near the Cloister and the Tower, the Great Hall offers a superb meeting, learning and leisure environment for a variety of group functions.

MEETING ROOM DIMENSIONS

	ROOM DIMENSIONS/ CEILING HEIGHT	SQ. FEET	SQ. METERS	MAXIMUM CAPACITY:				
				THEATER	CLASSROOM	RECEPTION	BANQUET	CONFERENCE
Great Hall (Stage)	144' × 95' × 23'	13,680	1,271	1,330	728	1,500	864	–
Great Hall South (Stage)	96' × 95' × 23'	9,120	847	816	432	800	528	–
Great Hall North	95' × 48' × 23'	4,560	424	473	240	400	288	60*
Granada Room	92' × 35' × 10'	3,220	299	336	220	275	276	60*
Granada Rooms A-B-C-D (each)	35' × 23' × 10'	805	75	70	50	75	60	30
Barcelona Room	92' × 35' × 10'	3,220	299	336	220	275	240	60*
Barcelona Rooms A-B-C-D (each)	35' × 23' × 10'	805	75	70	50	75	60	30
Seville	40' × 37' × 10'	1,470	137	198	80	150	108	38
Madrid	40' × 37' × 10'	1,470	137	198	80	150	108	38
Camino Hall	96' × 48' × 13'	4,608	428	528	272	700	360	88
Camino Foyer	70' × 25' × 11'	1,758	163	–	–	500	–	–
Garden Pool	–	–	–	–	–	1,200	720	–
Camino Garden	–	–	–	–	–	275	180	–
Flow House	–	–	–	–	–	350	200	–

*Recommend hollow square or rectangular set up



THE YACHT CLUB

Home to some of the Resort's most elegant meeting rooms, the Yacht Club's lavish décor includes Mediterranean art and antiques, Venetian chandeliers and rich European fabrics. An exceptional venue for executive events, Yacht Club meeting rooms overlook a classic terrace and fountain, inspired by the great palaces of Venice, and many feature Intracoastal views.

MEETING ROOM DIMENSIONS

	ROOM DIMENSIONS/ CEILING HEIGHT	SQ. FEET	SQ. METERS	MAXIMUM CAPACITY:				
				THEATER	CLASSROOM	RECEPTION	BANQUET	CONFERENCE
Amalfi Room	43' x 44' x 13'6"	1,935	180	177	80	278	120	43
CAPRI ROOM		1212	113	105	56	180	96	40
Salon I	24' x 24' x 13'6"	606	56	50	24	90	48	16
Salon II	24' x 24' x 13'6"	606	56	50	24	90	48	16
PORTOFINO ROOM	35' x 25' x 13'8"	890	83	74	40	130	60	24
Salon I	17' x 25' x 13'8"	468	43	40	18	65	24	16
Salon II	17' x 25' x 13'8"	442	41	36	15	65	24	16
Santa Margherita Room	48' x 27' x 13'8"	1,113	103	130	64	161	96	38
VENETIAN ROOM	41' x 58' x 13'8"	2,230	207	252	119	336	144	48
Salon I	24' x 24' x 13'6"	1,115	104	120	58	108	72	30
Salon II	24' x 24' x 13'6"	1,115	104	120	58	108	72	30
Yacht Club Office	15' x 10' x 10'	150	14	-	-	-	-	-

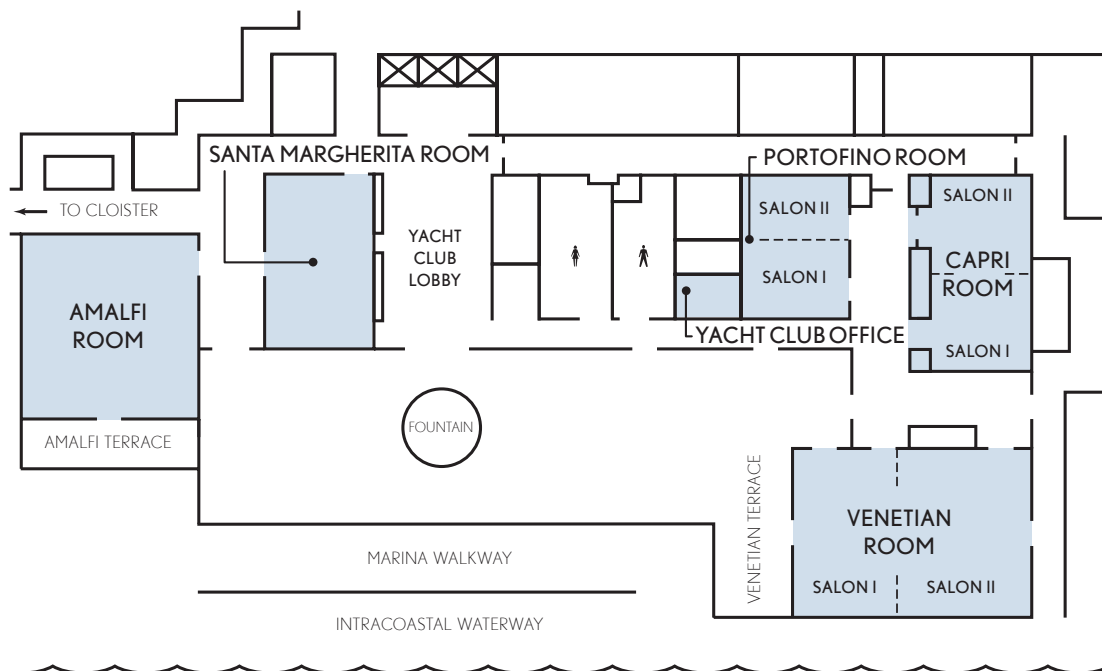

THE TOWER

Attend or conduct your meeting in a relaxing atmosphere at the Tower, with first and second floor meeting rooms overlooking the Intracoastal Waterway and the Resort's gardens. The Tower is one of the Resort's most popular locations for 50 people or less.

MEETING ROOM DIMENSIONS

	ROOM DIMENSIONS/ CEILING HEIGHT	SQ. FEET	SQ. METERS	MAXIMUM CAPACITY:				
				THEATER	CLASSROOM	RECEPTION	BANQUET	CONFERENCE
Vidal Room	32' x 18' x 10"	576	54	48	28	50	36	26
Northeast Kingman	32' x 18' x 10"	576	54	48	28	50	36	26
Bassford Room	32' x 18' x 10"	576	54	48	28	50	36	26
Southeast Kingman	32' x 18' x 10"	576	54	48	28	50	36	26
Tower Card Room	32' x 18' x 10"	576	54	48	28	50	36	26
Tower Suite D	32' x 18' x 10"	576	54	48	28	50	36	26

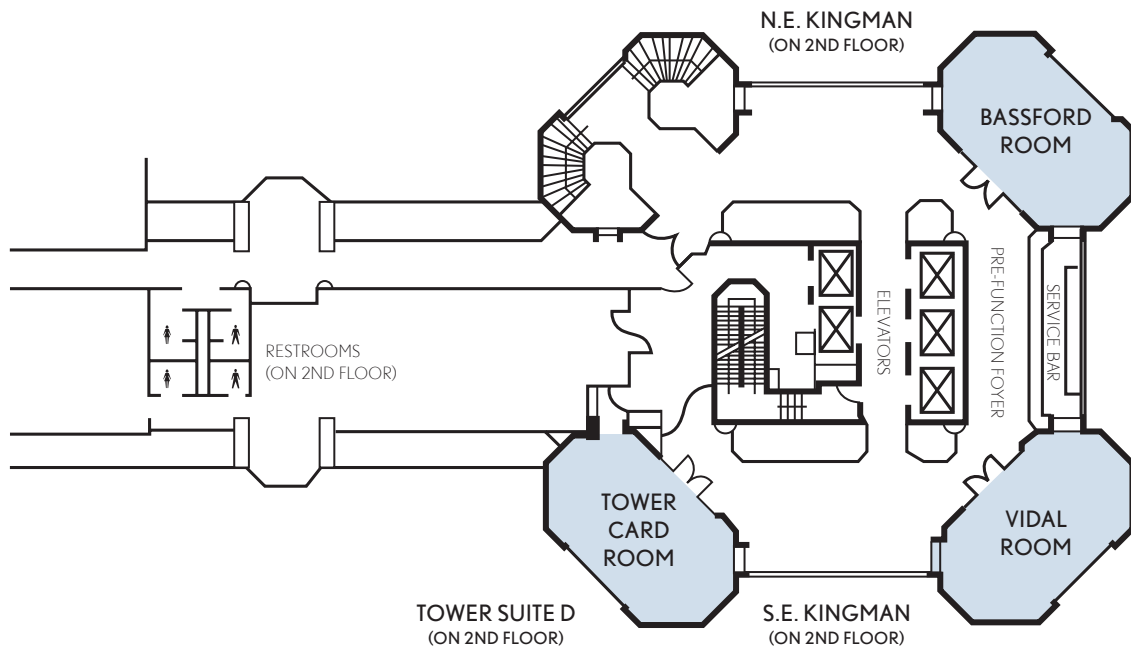

BOCA BEACH CLUB

Let the fresh, modern elegance and lively, youthful spirit of the Beach Club provide the setting for your next meeting or event. Handsome boardrooms are perfect for an intimate board of directors' retreat or executive conference. Choose to host your gala event beneath sparkling chandeliers in the Dunes Ballroom and enjoy your cocktail reception on the ocean-view terrace. Lush landscaped areas surrounding the Beach Club's three pools are ideal for festive outdoor parties and special events.

MEETING ROOM DIMENSIONS

	ROOM DIMENSIONS/ CEILING HEIGHT	SQ. FEET	SQ. METERS	MAXIMUM CAPACITY:				
				THEATER	CLASSROOM	RECEPTION	BANQUET	CONFERENCE
The Dunes Ballroom	75' x 60' x 8'9"	4,575	425	350	180	500	310	64
The Dunes Terrace	70' x 28'6" x 8'6"	1,907	177	-	-	175	-	-
The Dunes Patio	-	3,177	295	-	-	230	-	-
		1,364 (covered)						
Surfside A	28' x 33' x 8.6'	879	82	74	30	90	60	24
Surfside B	28' x 30' x 8.6'	786	73	64	30	80	50	24
Surfside C	28' x 26' x 8.6'	706	66	54	24	70	40	16
Surfside AB	63' x 28'	1,655	154	128	66	175	100	56
Surfside BC	56' x 28' x 8'6"	1,492	139	112	60	150	90	48
Surfside ABC	89' x 28' x 8'6"	2,370	220	189	96	230	150	80
Coral	29' x 21' x 8'6"	626	58	56	27	75	48	20
Reef	29' x 21' x 8'6"	622	58	56	32	75	48	20
Cove	44' x 21' x 8'6"	938	87	97	42	110	70	32
Tides	44' x 21' x 8'6"	950	88	98	42	110	70	32
OUTDOOR AREAS								
Pool Deck	322.5' x 720.6'	101,227	9,404	-	-	1,700	1,400	-
Atlantic & Fitness Pool	265.9' x 448.9'	6,4941	6,033	-	-	950	760	-
Cabana Pool	322.5' x 271.7'	41,447	3,851	-	-	450	360	-

BOCA BEACH CLUB

SECOND FLOOR

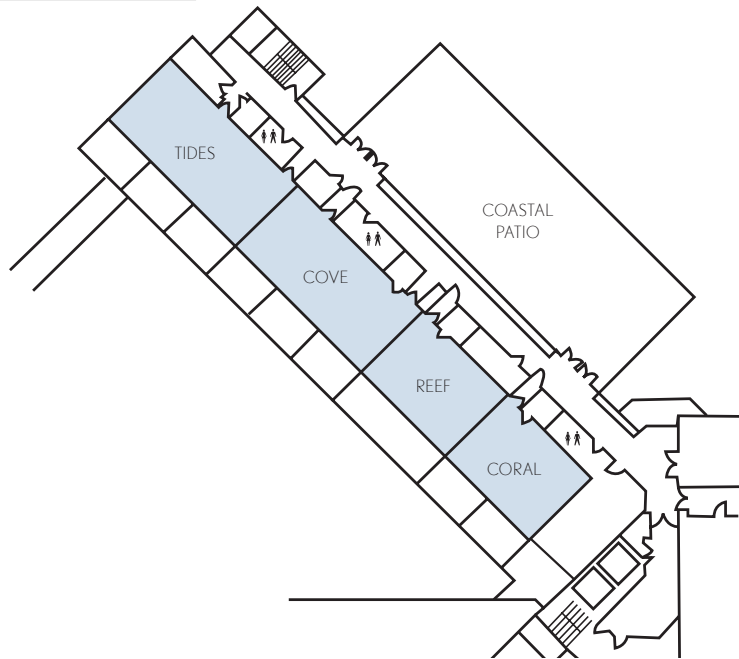

FIRST FLOOR

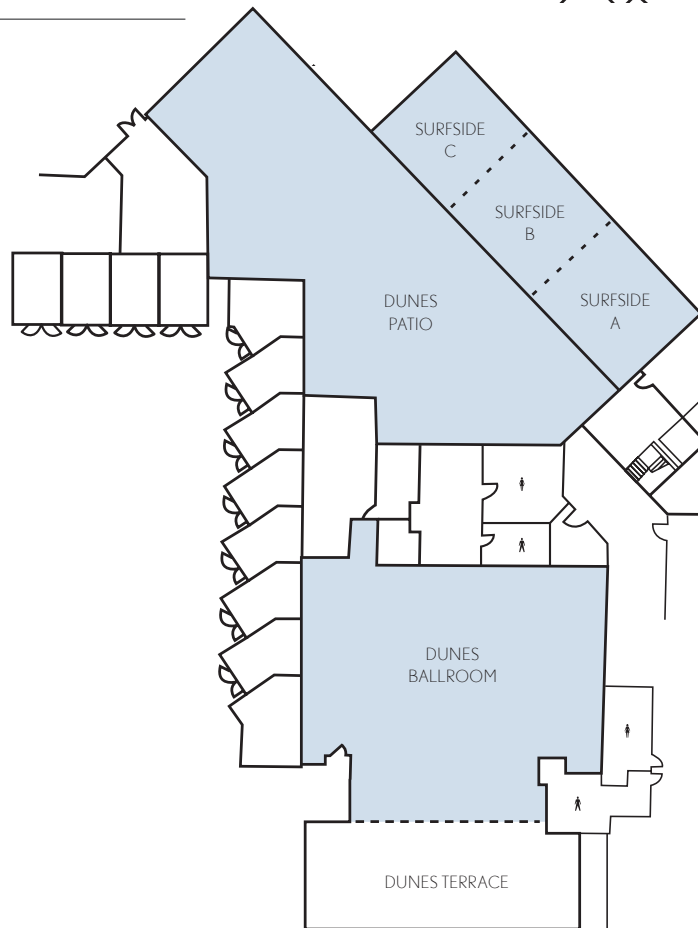

BEACH CLUB POOL DECK



BOCA RATON RESORT & CLUB[®]

A WALDORF ASTORIA[®] RESORT



501 EAST CAMINO REAL, BOCA RATON, FLORIDA 33432
561.447.3000 | BOCARESORT.COM

