



BOCA RATON RESORT & CLUB[®]

A WALDORF ASTORIA[®] RESORT

MEETINGS & EVENTS

CAPACITIES | DIMENSIONS

THE MIZNER CENTER

An elegant 128,000 square foot meeting venue, the Mizner Center offers 80,000 square feet of flexible function space, supported by a team of expert conference associates and the latest business technology. The Grand Lawn and Spanish Terrace augment the well-appointed rooms, offering year round use of outdoor spaces overlooking expansive lawns and gardens.

MEETING ROOM DIMENSIONS

	ROOM DIMENSIONS/ CEILING HEIGHT	SQ. FEET	MAXIMUM CAPACITY:				
			THEATER	CLASSROOM	RECEPTION	U-SHAPE	BANQUET
Grand Ballroom	138' x 183' x 22'9"	26,037	2,700	1,296	2,700	-	1,764
Salons A-D (each)	34' x 60' x 22'9"	2,158	234	108	230	56	156
Salons E-F (each)	138' x 31' x 22'9"	4,393	408	184	450	-	270
Salons G-J (each)	34' x 60' x 22'9"	2,158	234	108	230	56	156
Salons A-E, F-J	138' x 91' x 22'9"	13,025	1,408	704	1,370	-	840
Grand Pre-Assembly	45' x 206' x 22'	10,200	-	-	1,000	-	540
Royal Palm Ballroom	126' x 115' x 18'	15,027	1,664	816	1,579	-	1,080
Salons I-IV (each)	41' x 29' x 18'	1,235	126	66	120	38	72
Salons V-VI (each)	22' x 115' x 18'	2,506	232	144	263	-	228
Salons VII-X (each)	41' x 29' x 18'	1,235	126	66	120	38	72
Salons I-V, VI-X	63' x 115' x 18'	7,446	840	444	743	120	480
Royal Palm Pre-Assembly	121' x 60' x 18'	7,260	-	-	400	-	216
Addison Ballroom	48' x 95' x 14'9"	4,726	484	240	425	96	336
East	48' x 48' x 14'9"	2,304	220	112	200	51	144
West	48' x 48' x 14'9"	2,304	220	112	200	51	144
Addison Pre-Assembly	45' x 30' x 14'3"	1,375	-	-	75	-	-
Estate Ballroom	48' x 76' x 14'9"	3,895	432	228	375	-	240
Salon I - II - III	48' x 26' x 14'9"	1,355	132	64	125	44	96
Salon I - II, II - III	48' x 26' x 14'9"	2,710	264	140	125	56	144
Veranda Salons							
Salon I - II (each)	21' x 22' x 14'9"	465	36	24	40	16	36
Salon III - IV (each)	20' x 32' x 14'9"	758	56	30	70	27	36
Registration N/S	23' x 9'	207	-	-	-	-	-
Registration North Storage	9' x 7'	63	-	-	-	-	-
Registration South Storage	14' x 31'	434	-	-	-	-	-
Office I	40' x 20' x 12'	1,600	-	-	-	-	-
OUTDOOR AREAS							
Spanish Terrace	90' x 23'	3,000	-	-	240	-	156
Grand Lawn	95' x 92'	9,000	-	-	1,200	-	756

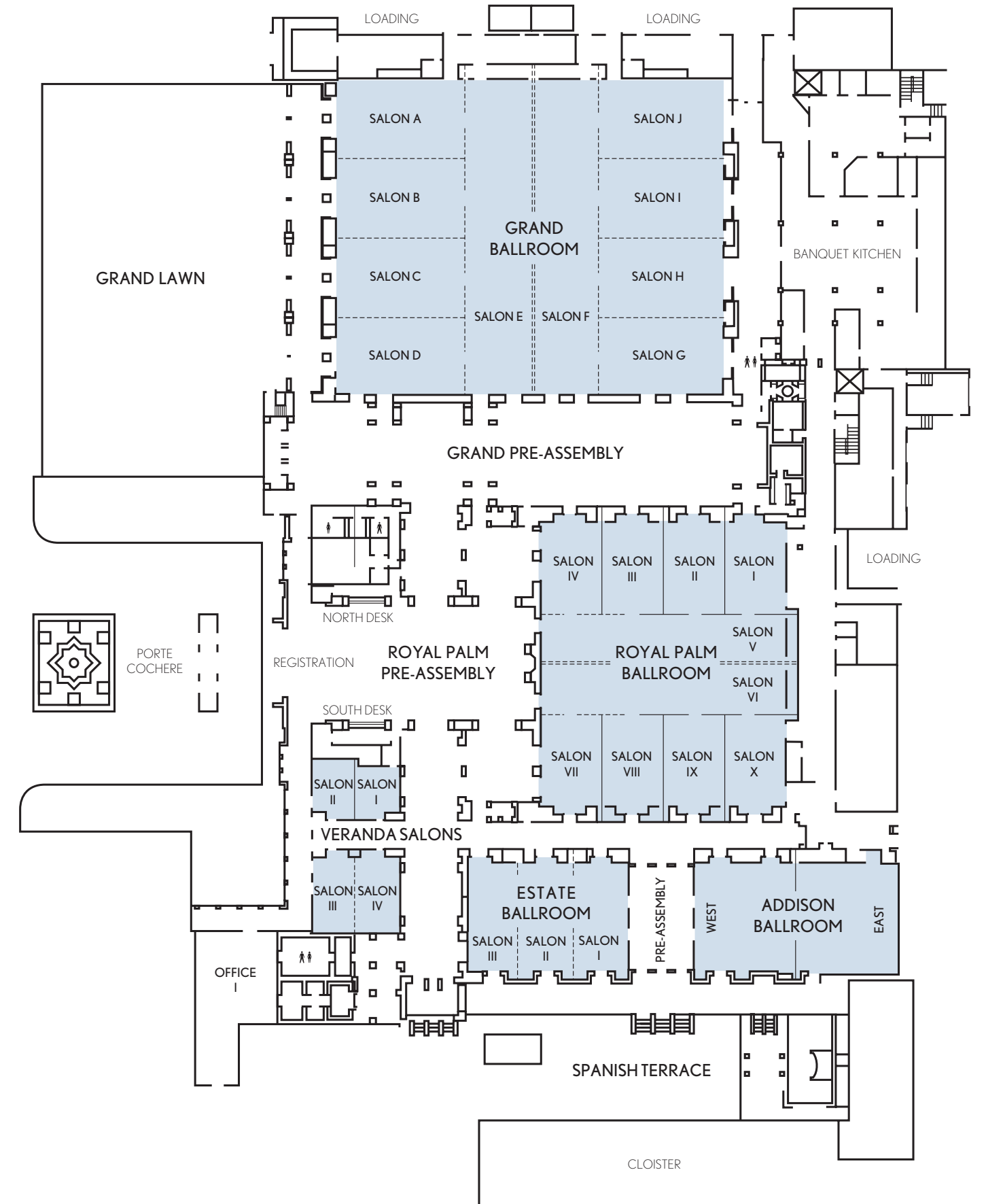

THE CLOISTER

A unique blend of vintage elegance and charm, the Resort's original signature building, The Cloister, is home to some of our most unique indoor and outdoor meeting venues, including the Cathedral dining room and Cloister Garden. While historic in nature and design, these rooms feature state-of-the-art audio/visual capabilities, a wide array of catering options and the attentive, yet unobtrusive, service for which the Resort is known.

MEETING ROOM DIMENSIONS

	ROOM DIMENSIONS/ CEILING HEIGHT	SQ. FEET	MAXIMUM CAPACITY:					
			THEATER	CLASSROOM	RECEPTION	BANQUET	U-SHAPE	CONFERENCE
Cathedral	102' x 59' x 11'	6,045	300	100	400	336	-	-
Valencia (Stage)	55' x 51' x 16'	2,805	288	152	300	168	58	46
Galeria	75' x 41' x 9'	3,075	259	99	250	168	71	64
Galeria North	41' x 36' x 9'	1,599	112	48	100	84	31	24
Galeria South	41' x 36' x 9'	1,599	112	48	100	84	31	24
Mizner Room	54' x 37' x 10'	1,944	234	96	200	144	50	46
OUTDOOR AREAS								
Cloister Garden	50' X 119"	-	-	-	300	156	-	-

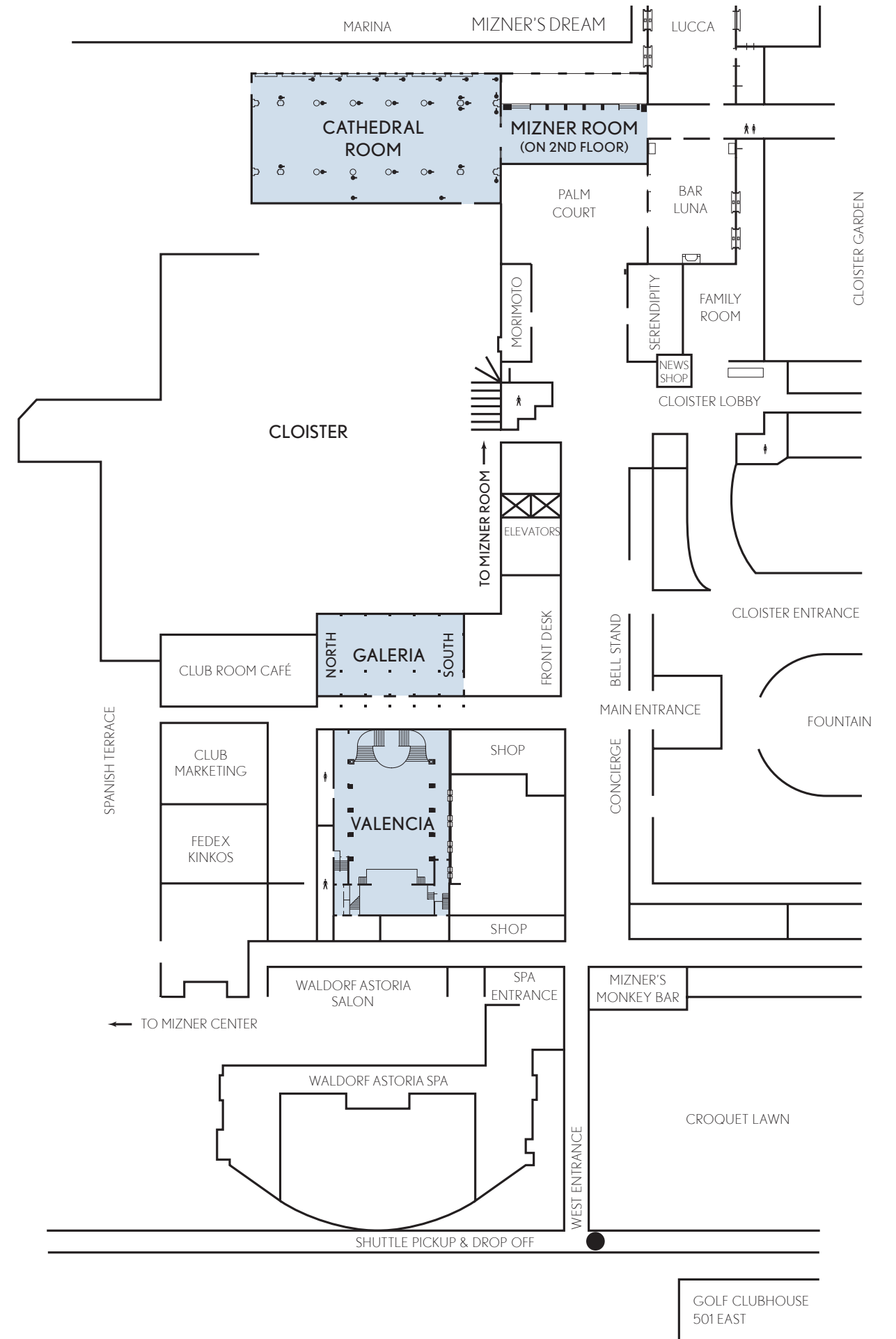

THE YACHT CLUB

Home to some of the Resort's most elegant meeting rooms, the Yacht Club's lavish décor includes Mediterranean art and antiques, Venetian chandeliers and rich European fabrics. An exceptional venue for executive events, Yacht Club meeting rooms overlook a classic terrace and fountain, inspired by the great palaces of Venice, and many feature Intracoastal views.

MEETING ROOM DIMENSIONS

	ROOM DIMENSIONS/ CEILING HEIGHT	SQ. FEET	MAXIMUM CAPACITY:					
			THEATER	CLASSROOM	RECEPTION	BANQUET	U-SHAPE	CONFERENCE
Amalfi Room	43' x 44' x 13'6"	1,935	177	80	278	120	52	43
Amalfi Terrace	21' x 22'	462	-	-	130	36	-	-
Capri Room	24' x 48' x 13'6"	1,212	105	56	180	96	43	40
Salon I - II (each)	24' x 24' x 13'6"	606	50	24	90	48	20	16
Portofino Room	35' x 25' x 13'8"	890	74	40	130	72	30	24
Salon I - II (each)	17' x 25' x 13'8"	468	40	18	65	24	18	16
Santa Margherita Room	48' x 27' x 13'8"	1,113	114	48	161	72	38	32
Venetian Room	41' x 58' x 13'8"	2,230	252	119	336	144	54	48
Salon I - II (each)	24' x 24' x 13'6"	1,115	120	58	108	72	36	30
Venetian Terrace	49' x 34'	1,666	-	-	200	48	-	-
Yacht Club Office	15' x 10' x 10'	150	-	-	-	-	-	-

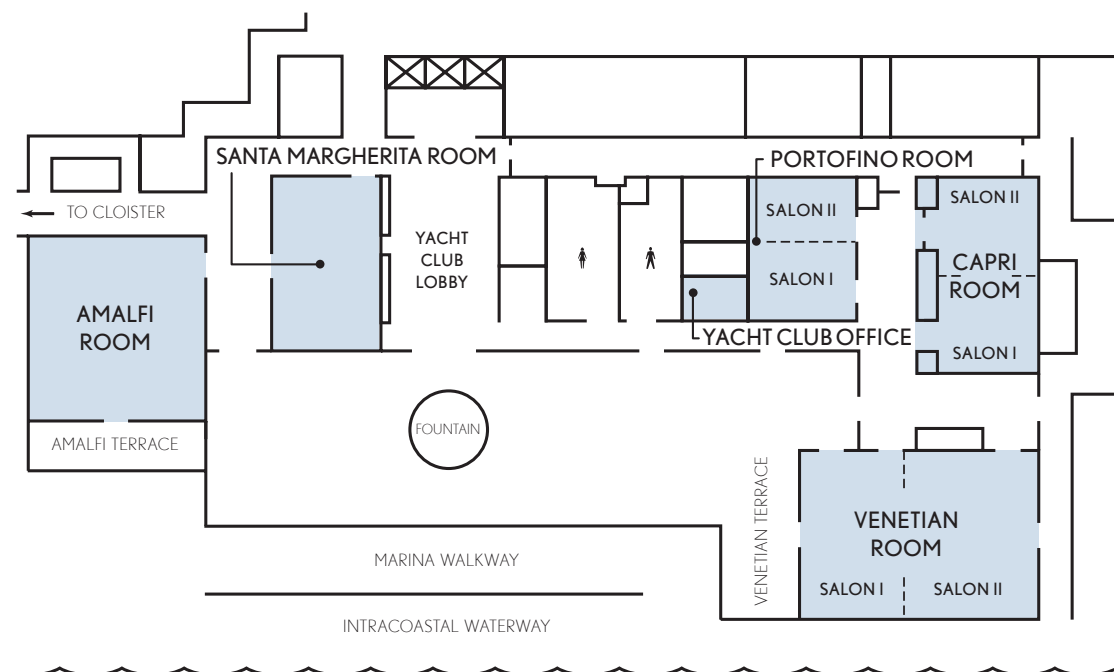

THE TOWER

Attend or conduct your meeting in a relaxing atmosphere at the Tower, with first and second floor meeting rooms overlooking the Intracoastal Waterway and the Resort's gardens. The Tower is one of the Resort's most popular locations for 50 people or less.

MEETING ROOM DIMENSIONS

	ROOM DIMENSIONS/ CEILING HEIGHT	SQ. FEET	MAXIMUM CAPACITY:					
			THEATER	CLASSROOM	RECEPTION	BANQUET	U-SHAPE	CONFERENCE
Vidal Room	32' x 18' x 10"	576	48	28	50	36	23	26
Northeast Kingman	32' x 18' x 10"	576	48	28	50	36	23	26
Bassford Room	32' x 18' x 10"	576	48	28	50	36	23	26
Southeast Kingman	32' x 18' x 10"	576	48	28	50	36	23	26
Tower Card Room	32' x 18' x 10"	576	48	28	50	36	23	26
Tower Suite D	32' x 18' x 10"	576	48	28	50	36	23	26
OUTDOOR AREAS								
Harbourside Pool	68'x231'	10,000	-	-	1,200	720	-	-

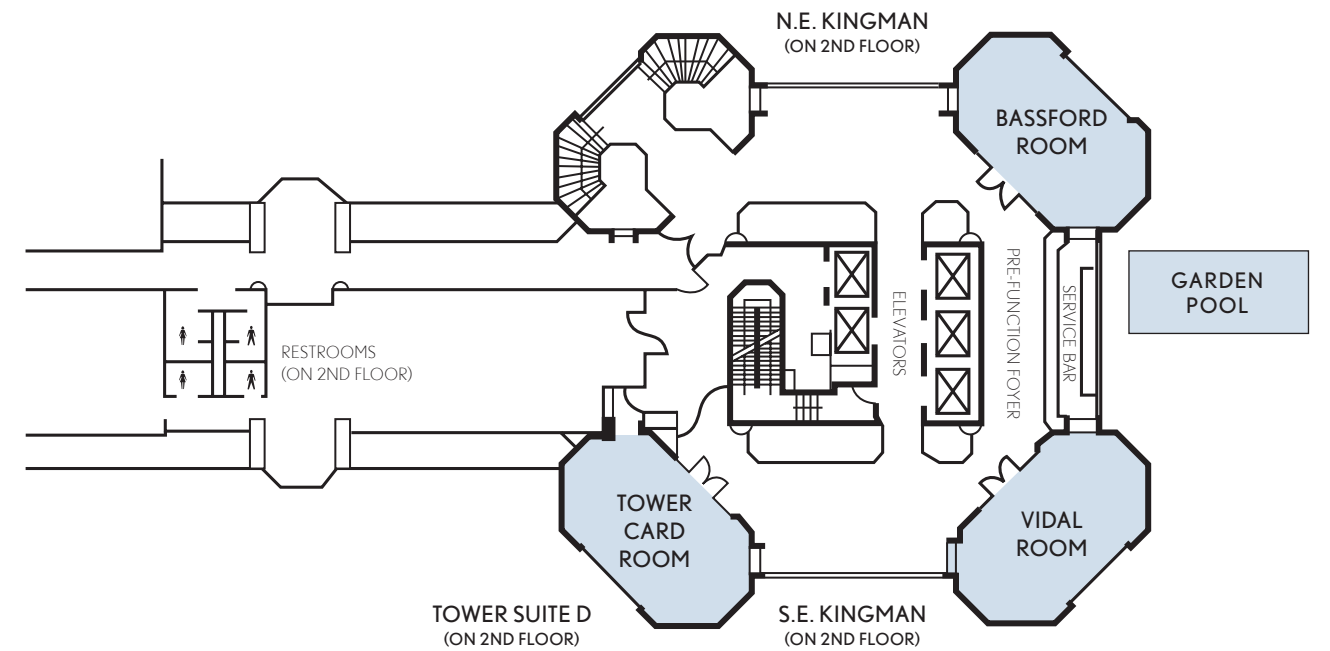

BEACH CLUB

Let the fresh, modern elegance and lively, youthful spirit of the Beach Club provide the setting for your next meeting or event. Handsome boardrooms are perfect for an intimate board of directors' retreat or executive conference. Choose to host your gala event beneath sparkling chandeliers in the Dunes Ballroom and enjoy your cocktail reception on the ocean-view terrace. Lush landscaped areas surrounding the Beach Club's three pools are ideal for festive outdoor parties and special events.

MEETING ROOM DIMENSIONS

	ROOM DIMENSIONS/ CEILING HEIGHT	SQ. FEET	MAXIMUM CAPACITY:					
			THEATER	CLASSROOM	RECEPTION	BANQUET	U-SHAPE	CONFERENCE
Dunes Ballroom	75' x 60' x 8'	4,575	350	180	500	310	72	64
Dunes Terrace	70' x 28'6" x 8'5"	1,907	-	-	230	120	-	-
Dunes Patio	-	3,177	-	-	380	-	-	-
Surfside A	28' x 28' x 8'5"	875	63	36	105	50	27	24
Surfside B	28' x 29' x 8'5"	786	60	30	105	40	20	18
Surfside C	28' x 26' x 8'5"	706	54	24	105	40	20	18
Surfside AB	28' x 63' x 8'5"	1,655	128	66	175	100	51	56
Surfside BC	28' x 56' x 8'5"	1,492	112	60	175	90	44	48
Surfside ABC	28' x 89' x 8'5"	2,370	189	96	230	150	76	80
Coral	29' x 21' x 8'5"	626	56	27	75	48	22	20
Reef	29' x 21' x 8'5"	622	56	32	75	48	22	20
Cove	44' x 21' x 8'5"	938	97	42	110	70	36	32
Tides	44' x 21' x 8'5"	950	98	42	110	70	36	32
Coastal Patio	92' x 34'	3,166	-	180	380	-	-	-
OUTDOOR AREAS								
Pool Deck	322.5' x 720.6'	101,227	-	-	3,428	1,714	-	-
Atlantic & Fitness Pool	265.9' x 448.9'	64,941	-	-	1,880	940	-	-
Cabana Pool	322.5' x 271.7'	41,447	-	-	450	630	-	-
North Lawn	100' x 65'	6,558	-	-	-	-	-	-

BOCA BEACH CLUB

SECOND FLOOR

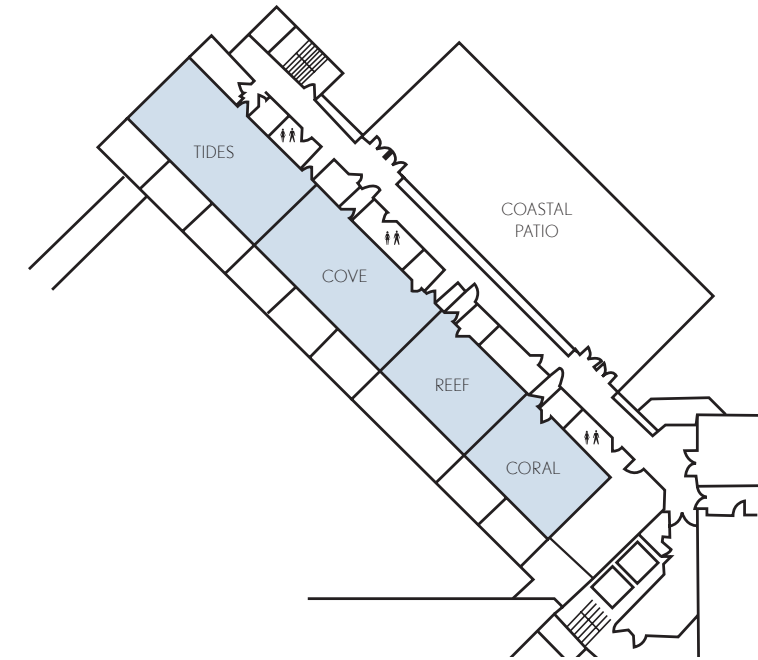

FIRST FLOOR

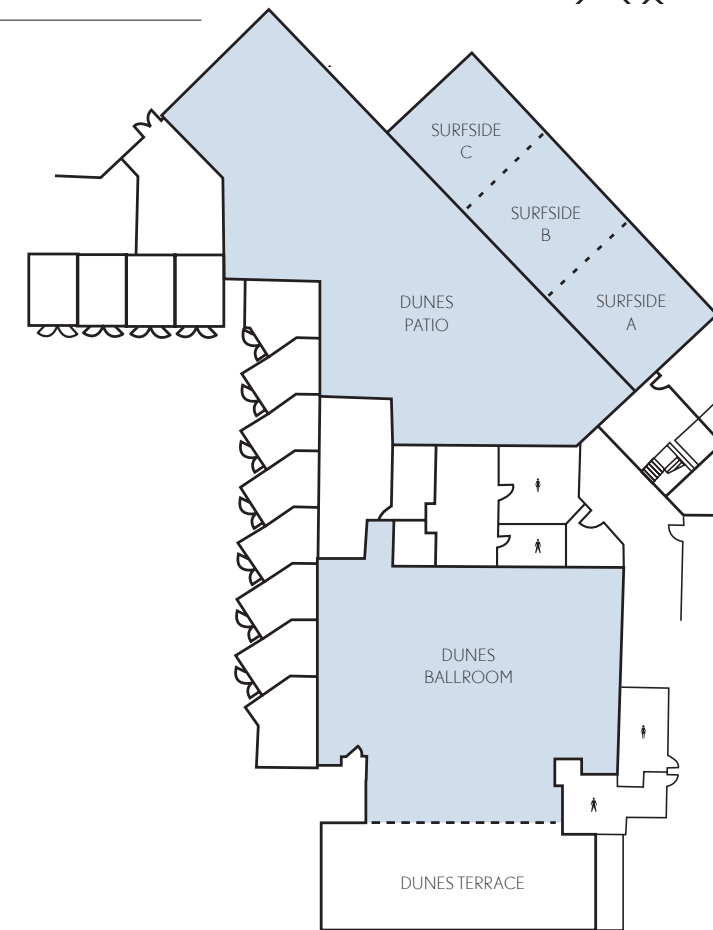

BEACH CLUB POOL DECK



BOCA RATON RESORT & CLUB[®]

A WALDORF ASTORIA[®] RESORT

501 EAST CAMINO REAL, BOCA RATON, FLORIDA 33432
561.447.3000 | BOCARESORT.COM